



VRLA Rechargeable Battery

FTH150-12

Pure Lead Battery for High Temperature



- Excellent high temperature performance
 - Special sealing compound to prevent any leaks
 - High compression and puncture resistance separator
 - Reinforced case resists high temperature condition
 - Special alloy inhibits corrosion under the highest temperature extremes
 - Electrolyte additive to prevent internal short circuit at high temperature
 - Advanced manufacturing techniques to ensure quality products
 - Broad operating temperature from -40°C to 85°C
 - Service Life — 10 Years.
- According to Eurobat (20 °C) — General Purpose

APPLICATION

- Solar
- Telecom
- Storage energy system
- Power station and UPS system
- IDC(Internet Data Center)



SPECIFICATIONS

Nominal Voltage	12 V
Nominal Capacity	150Ah @ 10 hour rate F.V.(1.75V/cell)
Approx. Weight	53.5kg(117.97lbs.)
Terminals	I2 (M6 Female Thread)
Internal Resistance	≤ 4mΩ (Fully Charged)
Max. Discharge Current	800 A (5 sec.)
Max. Charge Current	45 A
Operating Temperature Range	-40°C~65°C(-40°F~149°F)
Container Material	Standard: ABS(UL94 HB) FTH150-12 Optional: Flame Retardant ABS(UL94 V-0)FTH150-12FR



- IEC60896-21/22
- BS 6290/4
- GB/T 19638.2
- Eurobat guide

DIMENSION(mm/inch)

OUTER DIMENSIONS

TERMINAL TYPE

Length

560±2.0(22.05±0.08)

Width

125±2.0(4.92±0.08)

Container Height

290±2.0(11.42±0.08)

Total Height

290±2.0(11.42±0.08)

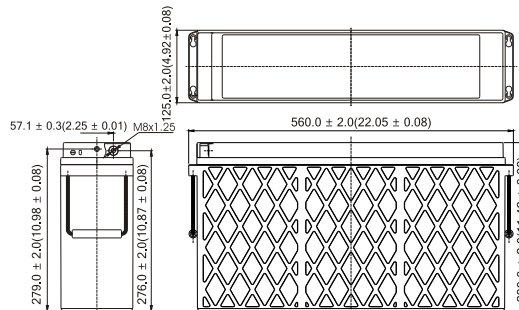

Terminal I2

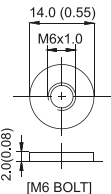

Terminal Hardware Initial Torque: 5.5 Nm ± 5%

Constant power discharge characteristics at 25 °C/77 °F

Unit: W

Discharge Time F.V. (V/cell)	15 Min	30 Min	45 Min	1 Hr	2 Hr	3 Hr	4 Hr	5 Hr	8 Hr	10 Hr	20 Hr
1.90V	1497	988	775	618	377	270	211	188.4	128.5	106.6	56.0
1.85V	1646	1090	848	684	415	295	231	204.8	139.7	115.9	60.9
1.80V	1748	1163	898	722	431	306	239	212.1	144.7	120.0	63.0
1.75V	1815	1203	928	738	440	309	243	214.2	146.1	121.2	63.7
1.70V	1854	1229	944	749	444	312	245	214.3	146.2	121.3	63.7
1.65V	1882	1244	957	759	448	316	247	214.3	146.2	121.4	63.7
1.60V	1900	1255	964	759	450	316	248	214.4	146.2	121.4	63.7

Constant current discharge characteristics at 25 °C/77 °F

Unit: A

Discharge Time F.V. (V/cell)	15 Min	30 Min	45 Min	1 Hr	2 Hr	3 Hr	4 Hr	5 Hr	8 Hr	10 Hr	20 Hr
1.90V	133	83	65	51.5	31.4	22.5	17.6	15.70	10.71	8.89	4.67
1.85V	148	92	71	57.3	34.6	24.6	19.3	17.06	11.64	9.66	5.07
1.80V	158	98	75	60.5	35.9	25.5	19.9	17.68	12.06	10.00	5.25
1.75V	164	102	78	62.0	36.6	25.8	20.3	17.85	12.17	10.10	5.30
1.70V	168	104	80	63.0	37.0	26.0	20.4	17.86	12.18	10.11	5.31
1.65V	170	106	81	63.9	37.3	26.3	20.6	17.86	12.19	10.12	5.31
1.60V	172	107	81	63.9	37.5	26.4	20.6	17.86	12.19	10.12	5.31

All data and artworks shall be changed without prior notice, BB reserves the right to explain and update the information contained hereinto.

For operation, please refer to the instruction from technical manual.

A/3 REV. Jul. 2021

Powered by **B.B. Tech(Changsha)Co., Ltd.**